

Courses and distances
from W.O down branch
Creek and cross creek
to Sugar tree.

- W.O. S. 57 1/2. E. 9.
- 2. N. 86 E. 12.
- 3. S. 30. E. 70
- 4. S. 15. E. 16
- 5. S. 22. E. 38.
- 6. S. 60. E. 28
- 7. N. 53. E. 36 1/2.
- 8. N. 80. E. 14.
- 9. S. 51. E. 21 Sugar tree.

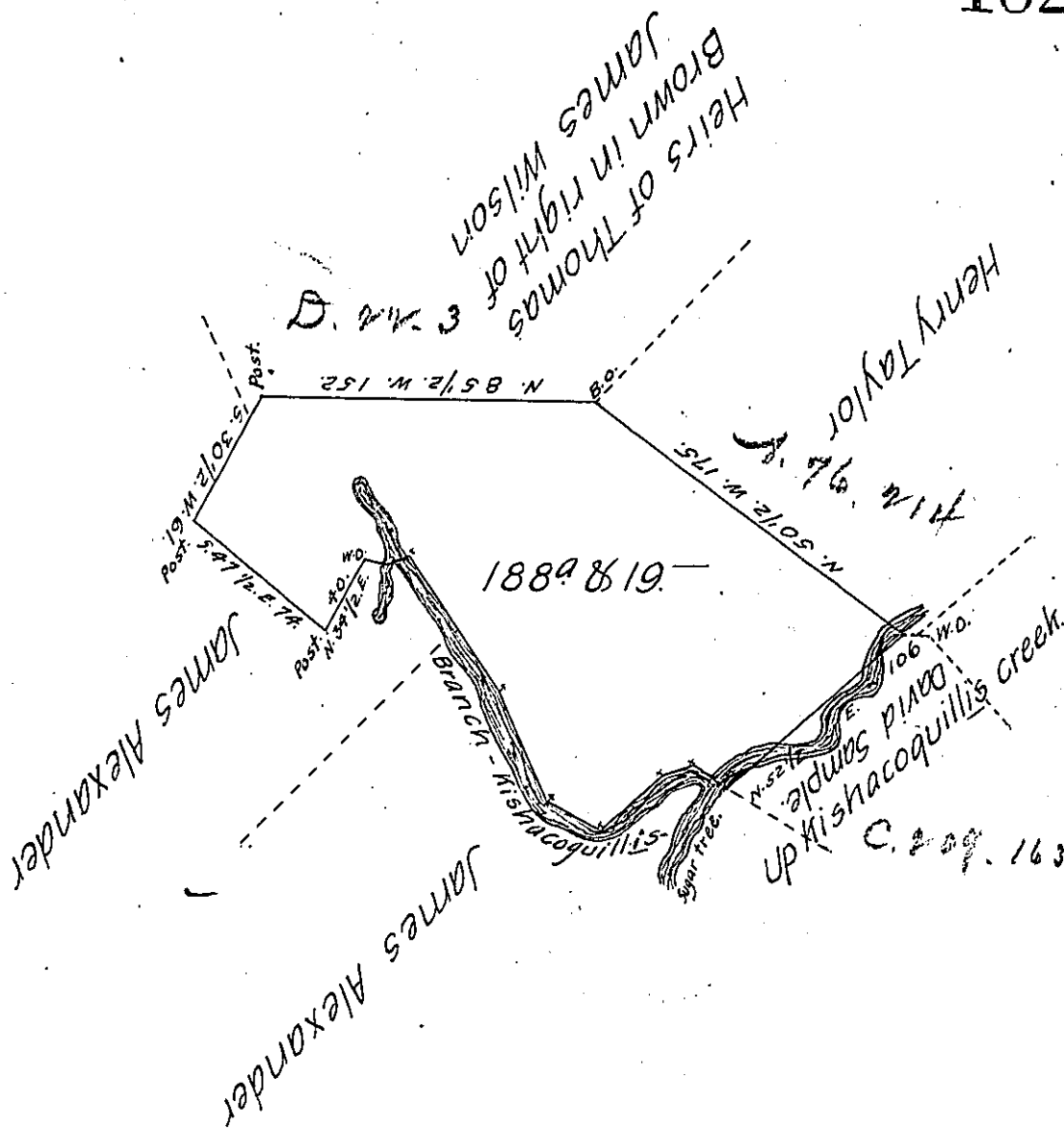

Draught of one hundred and eighty eight acres and nineteen perches of land with Six per Cent for Roads. Situate in Armagh township, in Kishacoquillis valley in Mifflin, late Cumberland county, Surveyed 25th August 1762, in pursuance of a Warrant to James Reed dat^d. 3^d June 1762. Resurveyed 7th November 1800 Examined 18th August 1814.

Michael M. Monahan—

To Richard T. Leech, Esquire,
Surveyor General of Pennsylvania

IN TESTIMONY that the above is a copy of the original remaining on file in the Department of Internal Affairs of Pennsylvania, made conformably to an Act of Assembly approved the 16th day of February 1833, I have hereunto set my hand and caused the Seal of said Department to be affixed at Harrisburg, this fourteenth day of January 1907.

Isaac R. Brown
Secretary of Internal Affairs.